

LUMEN SELECT™

PIERLUX ECO HIGHBAY GEN6



PRODUCT DETAILS

Rated life: L70 B10 54000hrs
 LED: 4000K/5000K, CRI80, 6SDCM
 Beam angle: Symmetrical, 115°
 Driver: Integral, Non-Dim, Lumen Select
 Rating: IP65, IK08, Class I
 Operating temperature: -20°C to +50°C
 Housing: Die-cast LM6 aluminium (copper content <0.1%)
 Finishing: Black, Powder coated
 Diffuser/Lens: Polycarbonate (PC), Clear
 Connection: Flex & Plug, Safety wire
 Accessory (order separately): Sensor, Sensor remote control, Surface mount kit, Polycarbonate refractor, Polycarbonate refractor lens, Aluminium reflector, Aluminium dust cover
 Warranty: 5 year

APPLICATIONS:

Suspended/Surface mounted (ceiling), Internal/External
 Warehousing, Industrial facilities, Workshops, Retail environments,
 Cold storage, Sports facilities

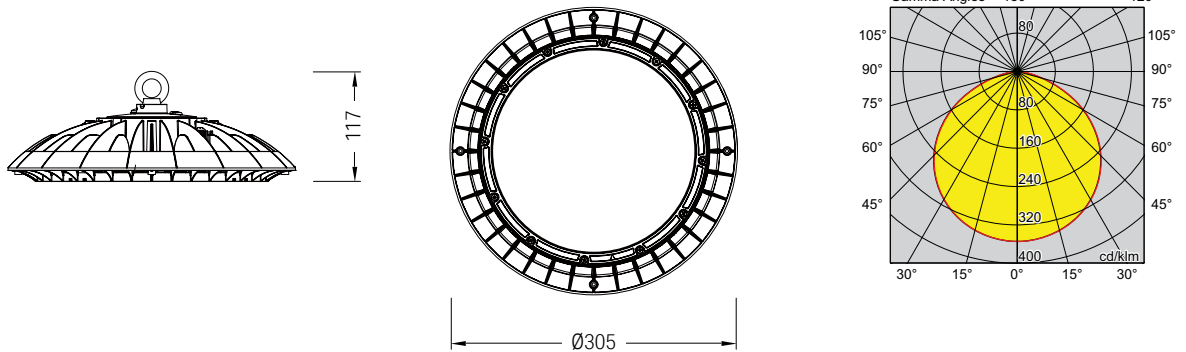

CODE	DESCRIPTION	POWER [~]	LUMENS [*]	EFFICACY	WEIGHT
ECOHB200W84LSG2	PIERLUX ECO HIGHBAY GEN6 LS @ 100W 4000K CRI80 NON-DIM	96W	16025LM	167LM/W	2.4KG
	PIERLUX ECO HIGHBAY GEN6 LS @ 150W 4000K CRI80 NON-DIM	147W	23933LM	167LM/W	2.4KG
	PIERLUX ECO HIGHBAY GEN6 LS @ 170W 4000K CRI80 NON-DIM	161W	25814LM	167LM/W	2.4KG
	PIERLUX ECO HIGHBAY GEN6 LS @ 200W 4000K CRI80 NON-DIM	190W	29916LM	167LM/W	2.4KG
ECOHB200W85LSG2	PIERLUX ECO HIGHBAY GEN6 LS @ 100W 5000K CRI80 NON-DIM	99W	17894LM	180LM/W	2.4KG
	PIERLUX ECO HIGHBAY GEN6 LS @ 150W 5000K CRI80 NON-DIM	149W	26017LM	174LM/W	2.4KG
	PIERLUX ECO HIGHBAY GEN6 LS @ 170W 5000K CRI80 NON-DIM	172W	29196LM	170LM/W	2.4KG
	PIERLUX ECO HIGHBAY GEN6 LS @ 200W 5000K CRI80 NON-DIM	204W	33746LM	166LM/W	2.4KG

[~]Tested system powers from luminaire. ^{*}Delivered lumens from luminaire, including thermal, electrical and optic losses. [^]Figures are interpolated / extrapolated from data at other versions.

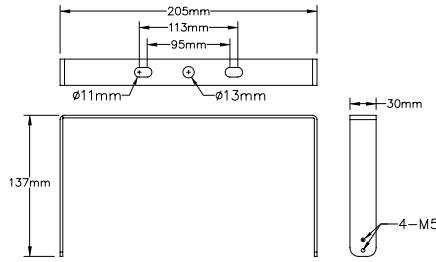

CODE: ECOHB170200BRKT 0.4KG
SURFACE MOUNT KIT

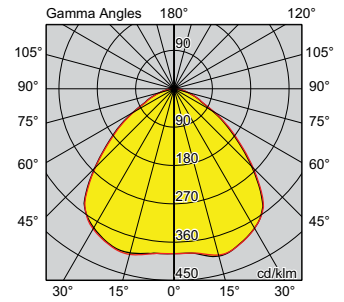
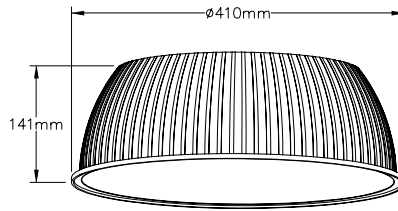

CODE: ECOHBG5PCREF 0.6KG
POLYCARBONATE REFRACTOR

CODE: ECOHBG5PCREFCOV 0.2KG
POLYCARBONATE REFRACTOR LENS

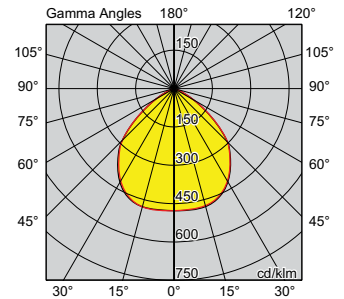
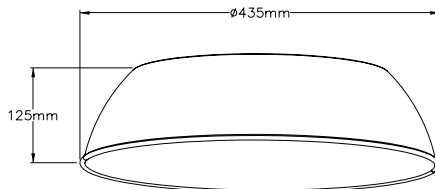

CODE: ECOHBG5ALREF 1.0KG
ALUMINIUM REFLECTOR

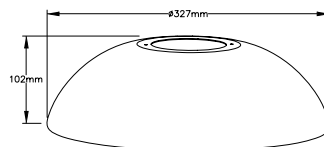

CODE: ECOHBG5LRCOV 0.4KG
ALUMINIUM DUST COVER

*UP TO 150W WHEN USING THE ALUMINIUM DUST COVER