

MONO WALL LIGHT

PRODUCT DETAILS

Rated life: L80 B20 50000hrs
 LED: 3000K/4000K, CRI80, 3SDCM
 Beam angle: Symmetrical 15°/24°/40°
 Driver: Integral, Non-Dim
 Rating: IP65, IK06, Class I
 Operating temperature: -10°C to +40°C
 Housing: Die-cast EN AB-47100 aluminium
 Finishing: White, Polyester powder coated with special anti-corrosion treatment for coastal areas, Salt Spray testing (in compliance with ISO 9227 standard)
 Diffuser/Lens: Tempered glass, Clear
 Warranty: 5 year



MADE TO ORDER OPTIONS (LEAD TIME AND MOQ MAY APPLY)

Direct & Indirect, Other lumen packages, Grey/Black finishing

APPLICATIONS

Surface mounted (wall), Internal/External
 Commercial buildings, Apartments, Residential areas

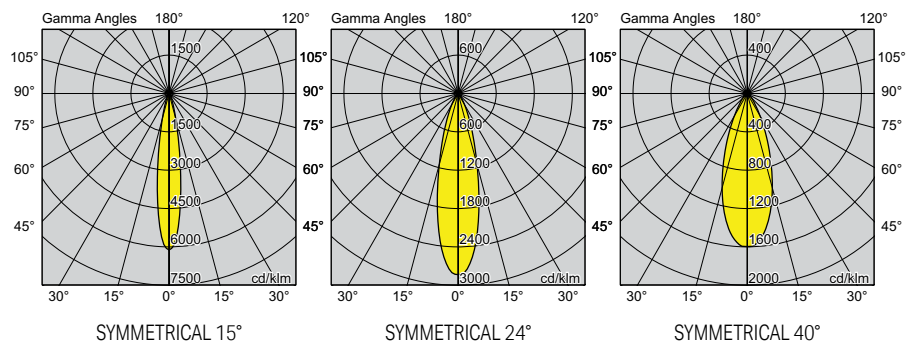
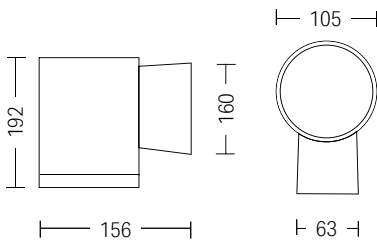

CODE	DESCRIPTION	POWER [~]	LUMENS*	EFFICACY	WEIGHT
E5550C-LBC-15	MONO WALL LIGHT 105C 13W 3000K CRI80 15° NON-DIM WHITE	12W	894LM	75LM/W	1.7KG
E5550C-LBC-24	MONO WALL LIGHT 105C 13W 3000K CRI80 24° NON-DIM WHITE	13W	1206LM	93LM/W	1.7KG
E5550C-LBC-40	MONO WALL LIGHT 105C 13W 3000K CRI80 40° NON-DIM WHITE	13W	1135LM	87LM/W	1.7KG
E5550C-LBN-15	MONO WALL LIGHT 105C 13W 4000K CRI80 15° NON-DIM WHITE	12W	963LM	80LM/W	1.7KG
E5550C-LBN-24	MONO WALL LIGHT 105C 13W 4000K CRI80 24° NON-DIM WHITE	13W	1274LM	98LM/W	1.7KG
E5550C-LBN-40	MONO WALL LIGHT 105C 13W 4000K CRI80 40° NON-DIM WHITE	13W	1193LM	92LM/W	1.7KG

[~] Tested system powers from luminaire. ^{*} Delivered lumens from luminaire, including thermal, electrical and optic losses. [^] Figures are interpolated / extrapolated from data at other versions.